



# VENUE SPACE GUIDE



**I-X CENTER**

One I-X Center, Cleveland, OH 44135

216-676-6000



# SPECIFICATIONS

## I-X CENTER | EXHIBIT HALLS, LOBBY & PRE-FUNCTION SPECIFICATIONS

	Space	Dimensions	Square Footage	Ceiling Height	10 X 10 Booths	Overhead Doors	Sound System
EXHIBIT HALLS	<b>MAIN LEVEL EXHIBIT HALLS</b>						
	HALL A	300' X 375'	112,500	55' - 77'	550	4	YES
	HALL B	220' X 375'	75,000	55' - 77'	365	4	YES
	HALL C	100' X 325'	32,500	55' - 77'	150	4	YES
	HALL C (HALF)	100' X 165'	16,500	55' - 77'	85	4	YES
	HALL D	206' X 400'	82,400	25'	410	66	NO
	HALL E	215' X 400'	86,000	25'	382	66	NO
	<b>LOWER LEVEL EXHIBIT HALL</b>						
	HALL F CONCOURSE	200' X 200'	40,000	11'	200	2	NO
	<b>LOBBY &amp; PRE-FUNCTION</b>						
	LOBBY		12,000	45'			YES
	CONCOURSE LOBBY		10,000	11'			NO
	MEETING SPACE PRE-FUNCTION		6,800	10'			NO

## GROSS SQUARE FEET

- Gross square feet is defined as total display area space including aisles. Aisle space shall be a minimum of ten (10) feet in width with floor plans approved by the Fire Marshal.
- When OVG Hospitality, the I-X Center's exclusive Food & Beverage provider, is permitted by the event to provide an area for food service with the gross exhibit floor area, the space will not be computer as part of the square footage occupied by Licensee.

## RENTAL RATES

- Lobby space used as an exhibit area shall be charged the minimum daily rate or thirty cents (\$.30) per gross square foot, whichever is greater, per day.
- The I-X Center will provide one complimentary move-in/out day for each show day; maximum of two; each additional day will be 50% of daily rental.
- Licensee will be charged close-off drape if required space is less than the full gross square footage of the requested hall.

## SERVICES INCLUDED

- Space in the pre-function area, to be used for registration purposes only, shall be provided to the Licensee at no additional charge based upon availability and assigned by the I-X Center's event team.
- In-house public address system (in hall only) is complimentary with one (1) standard wired microphone available upon request and within the limits.
- House lighting, heat and/or air conditioning are provided during event hours. An adequate level of lighting and comfort will be maintained during move-in/out hours.
- Free WiFi for light use like reading emails and web browsing provided in food concession area on the Main Level (Connectivity speeds up to 256k up/down).

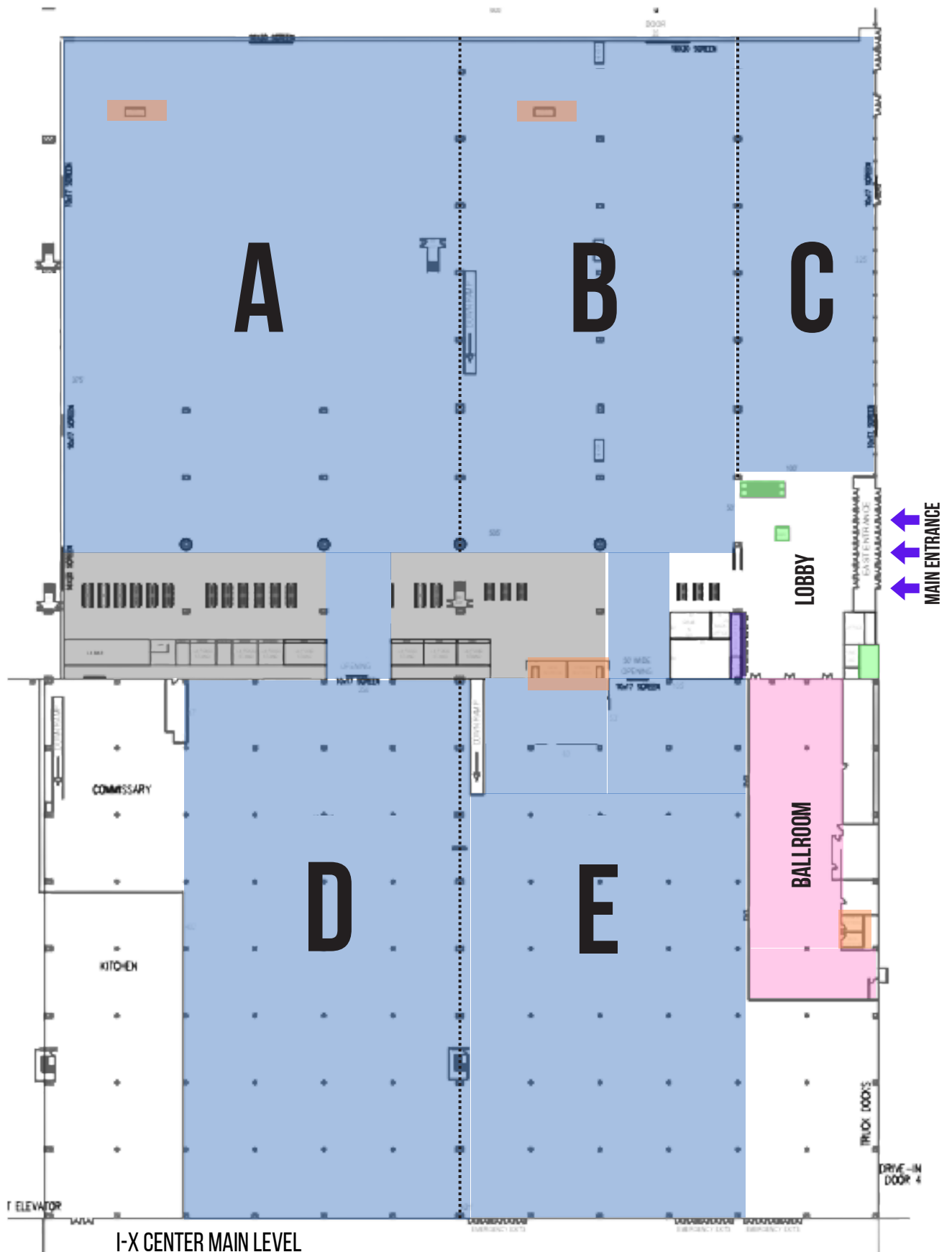

### I-X CENTER MAIN LEVEL

This space includes Halls A-E plus the Grand Ballroom.

#### KEY

- ➔ Entrances
- Restrooms
- Exhibit Halls
- Elevators, Escalator, Stairs
- Grand Ballroom
- Concessions

# SPECIFICATIONS

I-X CENTER | BALLROOM & MEETING ROOMS

Space	Dimensions	Square Footage	Ceiling Height	Theater	Classroom	Banquet	Sound System
<b>MAIN LEVEL BALLROOM</b>							
BALLROOM	237' X 67'	16,000	25'	1,200	550	800	YES
<b>NORTH MEETING ROOMS 1 - 10</b>							
N1	75' X 25'	1,875	10'	180	100	100	NO
N2	20' X 23'	460	10'	60	40	40	NO
N3	17' X 25'	425	9'	35	23	23	NO
N4	24' X 42'	1,008	10'	BOARDROOM - CAPACITY 24			NO
N5	24' X 40'	960	10'	100	66	66	NO
N6	23' X 25'	575	10'	62	40	40	NO
N7	49' X 84'	4,116	10'	433	220	280	YES
N8	24' X 59'	1,416	10'	150	90	90	NO
N9	24' X 40'	960	10'	100	66	66	NO
N10	24' X 35'	840	10'	100	65	65	NO
<b>SOUTH MEETING ROOMS 11 - 26</b>							
S11	40' X 26'	1,040	9'	100	66	66	YES
S12	25' X 50'	1,250	9'	125	83	83	YES
S13	50' X 24'	1,250	9'	125	83	83	YES
S14	25' X 50'	1,250	9'	125	83	83	YES
S15	49' X 50'	2,450	9'	250	166	166	YES
S16	49' X 50'	2,450	9'	250	166	166	YES
S17	49' X 50'	2,450	9'	250	166	166	YES
S18	49' X 50'	2,450	9'	250	166	166	YES
S19	25' X 50'	1,250	9'	125	83	83	YES
S20	25' X 50'	1,250	9'	125	83	83	YES
S21	25' X 50'	1,250	9'	125	83	83	YES
S22	25' X 50'	1,250	9'	125	83	83	YES
S23	25' X 50'	1,250	9'	125	83	83	YES
S24	25' X 50'	1,250	9'	125	83	83	YES
S25	25' X 50'	1,250	9'	125	83	83	YES
S26	25' X 50'	1,250	9'	125	83	83	YES

BALLROOM & MEETING ROOMS

## SERVICES INCLUDED:

- One-time standard room set of tables and chairs, within the limits and availability of I-X Center's inventory:
  - Room set options: Classroom, theater, banquet or conference/hollow square/u-shape
  - For banquet style, black or white linens will be provided at no additional charge
  - Room changeover fee applies
- House lighting, heat and/or air conditioning are provided during event hours. An adequate level of lighting and comfort will be maintained during move-in/out hours.
- One topped/skirted table and two chairs registration table.
- Free WiFi for light use like reading emails and web browsing provided in all meeting rooms (Connectivity speeds up to 256k up/down).

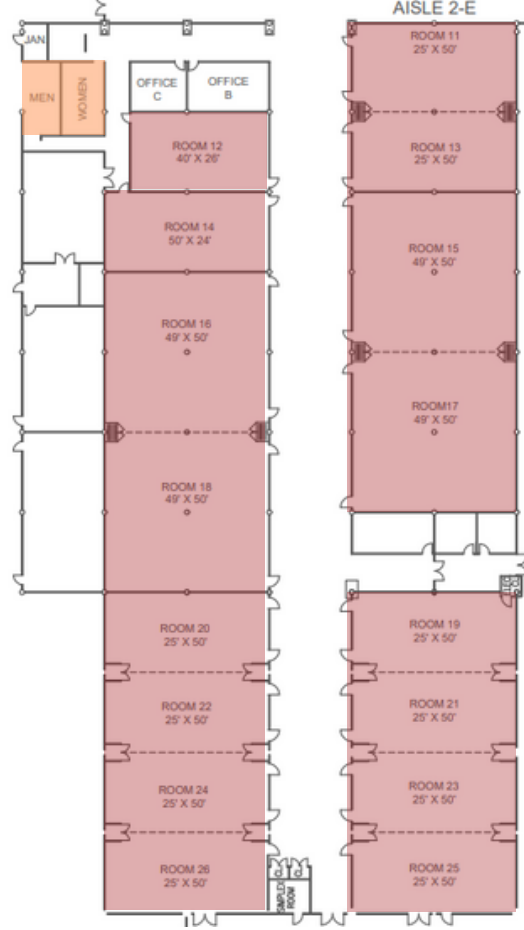
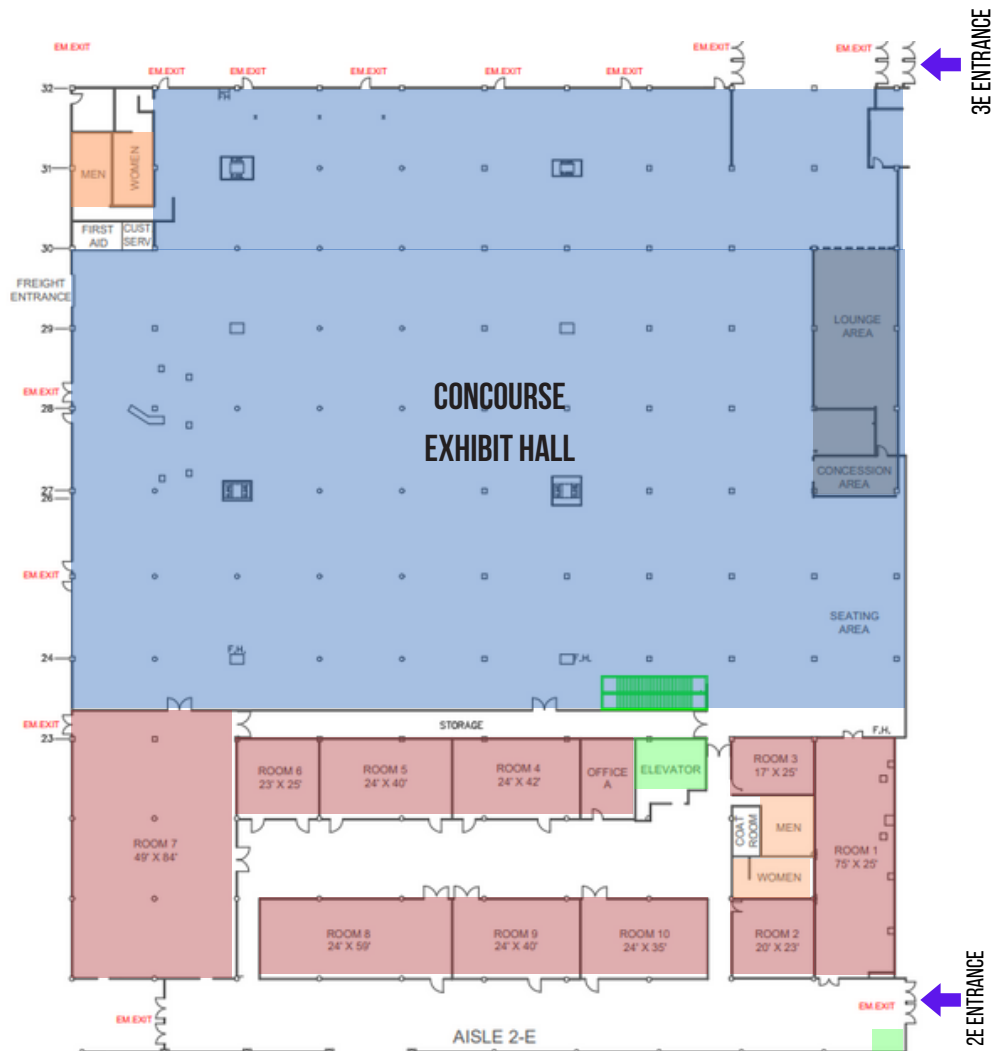

**I-X CENTER LOWER-LEVEL**  
 This space includes the lower-level exhibit hall, plus access to meeting rooms 1-26.

- KEY**
- ➔ Entrances
  - Exhibit Hall
  - Meeting Rooms
  - Restrooms
  - Elevators, Escalator, Stairs
  - Concessions